



Installation Instructions: MN6

NISSAN NAVARA KING / NP300 / UK 1861mm BED LENGTH

2015-CURRENT

TOOLS REQUIRED

- Adjustable spanner
- 13mm open end spanner
- #2 Phillips screwdriver
- 1/4" drive ratchet
- 11mm deep socket
- Wire cutters
- Electric drill
- 11mm drill bit
- 8mm drill bit
- 3.5mm drill bit
- Drill stop
- Self etching primer

Watch installation videos at [DECKED.com/installvideo](https://www.decked.com/installvideo) | Register your system at [DECKED.com/register](https://www.decked.com/register)



@DECKEDUSA | #DECKEDUSA

VERSION 4

DECKED.COM | 1-208-806-0251

CONTENTS

DECKED carton

- LEFT deck half - 1
- RIGHT deck half - 1
- Centre vert - 1
- Cabside vert - 1
- Drawer - 2
- Left ammo can - 1
- Right ammo can - 1
- Left stud - 1
- Right stud - 1
- Ammo can lid - 2
- C-channel - 2
- Ruler - 1
- Hardware box - 1
- Torsion brace - 1
- Closeout angle - 1

Hardware box - unbagged components

(Inside DECKED carton):

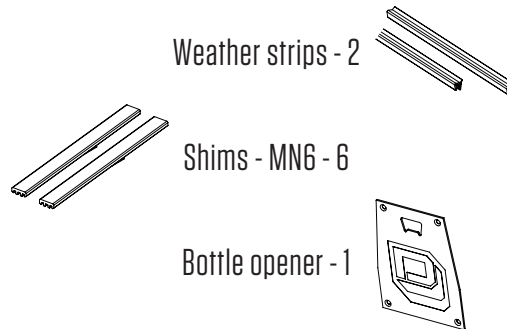

HARDWARE box - bagged components

- PREP MS1 - 1
- S1 - 1
- S2 - 1
- N1 - 1
- J8 - 2
- DRAWER 1 - 1
- DRAWER 2 - 1
- WHEELS - 1
- FINAL MID - 1
- PREP-EXTRA - 1
- MS WASHERS - 1

ASSEMBLY OVERVIEW

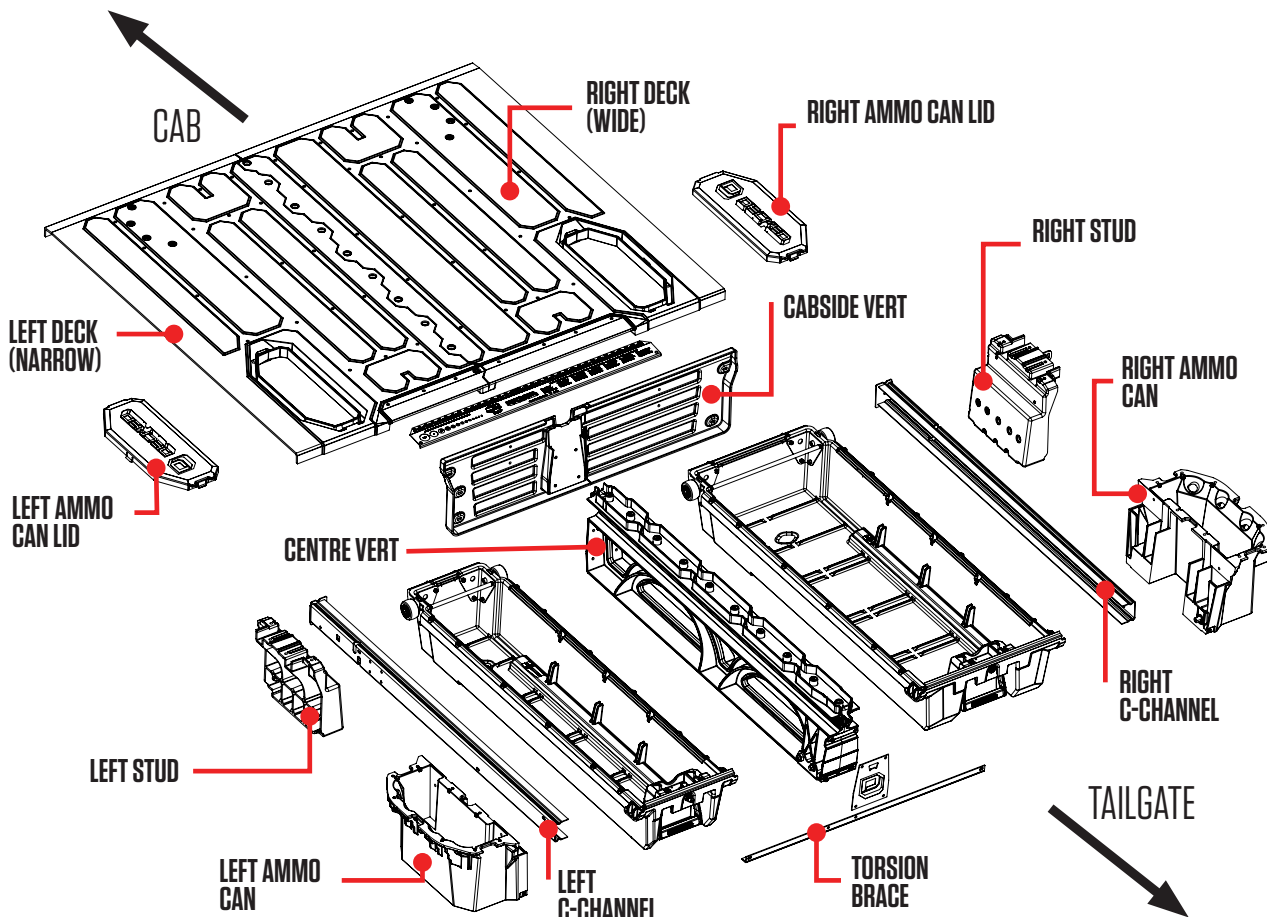

Need Help? Watch our installation videos or call us. We're happy to help!

DECKED.COM/INSTALLVIDEO | 208-806-0251

▼ HEY! TORQUE BOY: READ BEFORE YOU INSTALL DECKED ▼

1. **DON'T** be an idiot read the instructions.
2. **DON'T** over tighten bolts, get em' hand-tight.
3. **DON'T** use power tools.
4. If you don't follow directions and *do* use power tools:
 - 1). Set clutch at a very low setting. 2). If you blow it, see NOTE.*
5. **DON'T** over tighten J-hooks during installation. Make 'em good and snug enough to keep the system from moving in the bed.
6. There is a **LEFT** and **RIGHT** specific ammo can, The inside of each ammo can is marked L or R.

NOTE* Two extra threaded inserts are included in **BAG PREP-EXTRA**. That's all you get. The inserts will replace any stripped inserts in the tailgate ammo cans, but **NOT THE CENTRE VERT**, so hand tighten until snug only! You can also screw the inserts back in if dislocated. There is a straight screwdriver slot on the underside of the insert.

NOTE: You will need a buddy to help with exactly two steps, not including draining the sixpack.

NOTE: Hand thread screws into threaded inserts to get them started. This helps insure they will not cross thread.

Prevent abusive, expletive-filled language, watch our detailed installation video or give us a call. We're happy to help! 208.806.0251 | [DECKED.COM/INSTALLVIDEO](https://www.decked.com/installvideo)

PREP BED: MARK CENTRE OF BED

- Using a tape measure, locate the centreline of bed floor (blue), which may be raised or depressed. Mark centreline with marking pen or wax pencil.

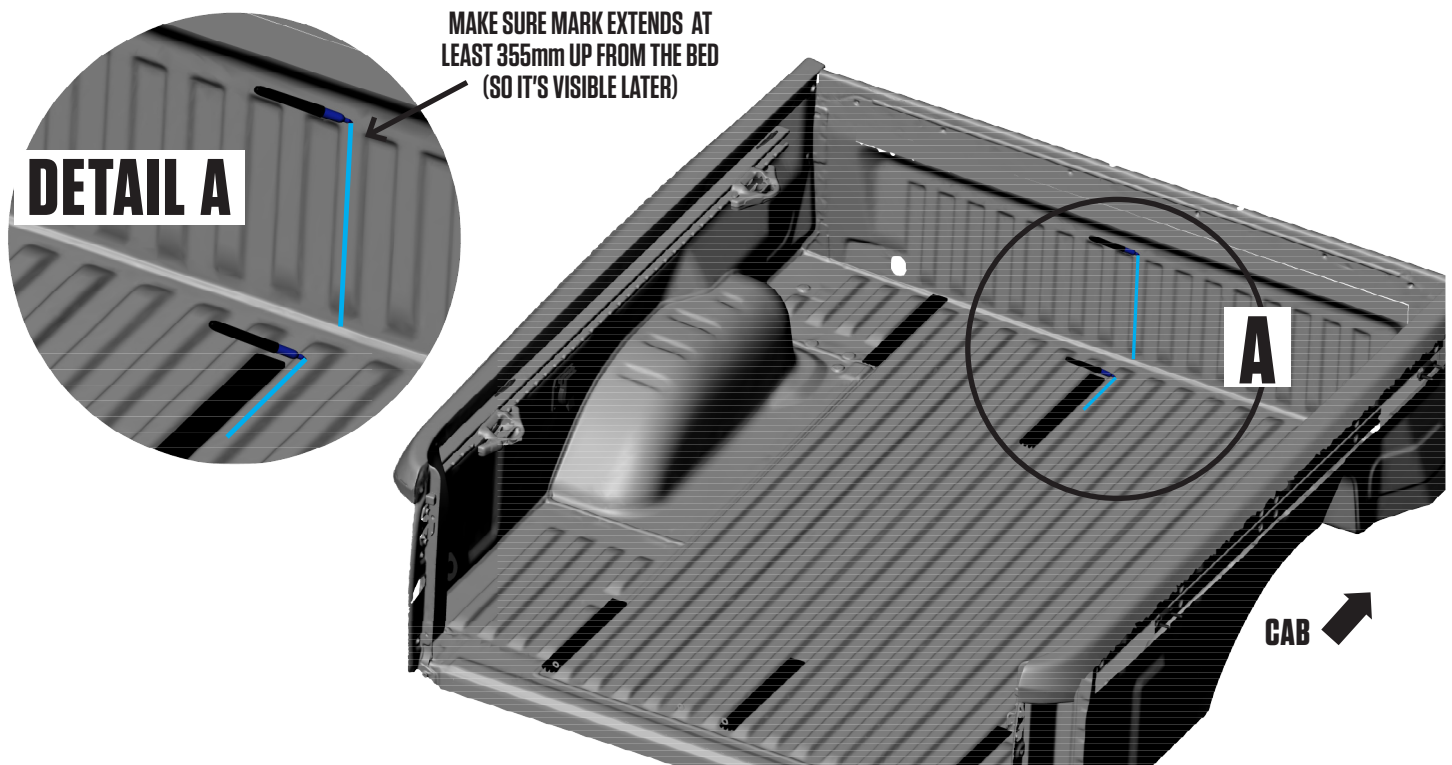

PREP BED: SHIMS

- There are **6 SHIMS** loose in the hardware kit.
- Using the information below:
 - 1) Clean the bed surface where the shims will be located. Isopropyl alcohol is recommended.
 - 2) Remove tape film and apply shim and apply with pressure.

DETAIL C

Align wide shim to channel in floor as shown against cabside panel of bed (red). Repeat on the right side of bed.

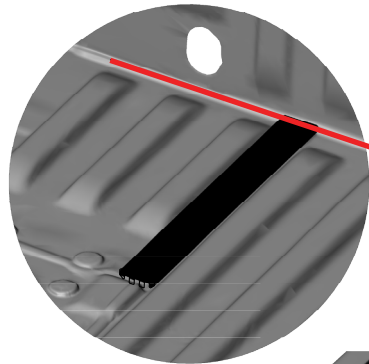

DETAIL D

Align narrow shim to channel in floor as shown 104mm from cabside panel of bed (red).

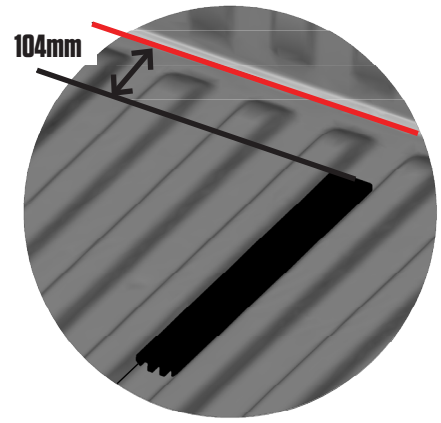

DETAIL B

Align narrow shim to channel in floor as shown 108mm from rear of bed (red). Repeat on the right side of bed.

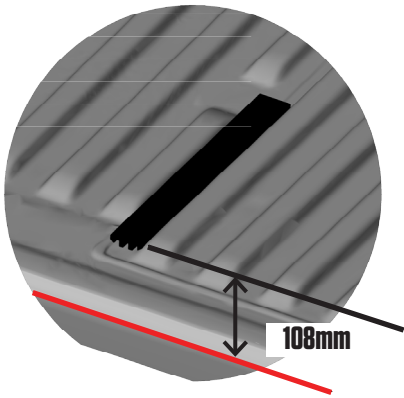

DETAIL A

Align shim to channel in floor as shown 108mm from rear of bed (red).

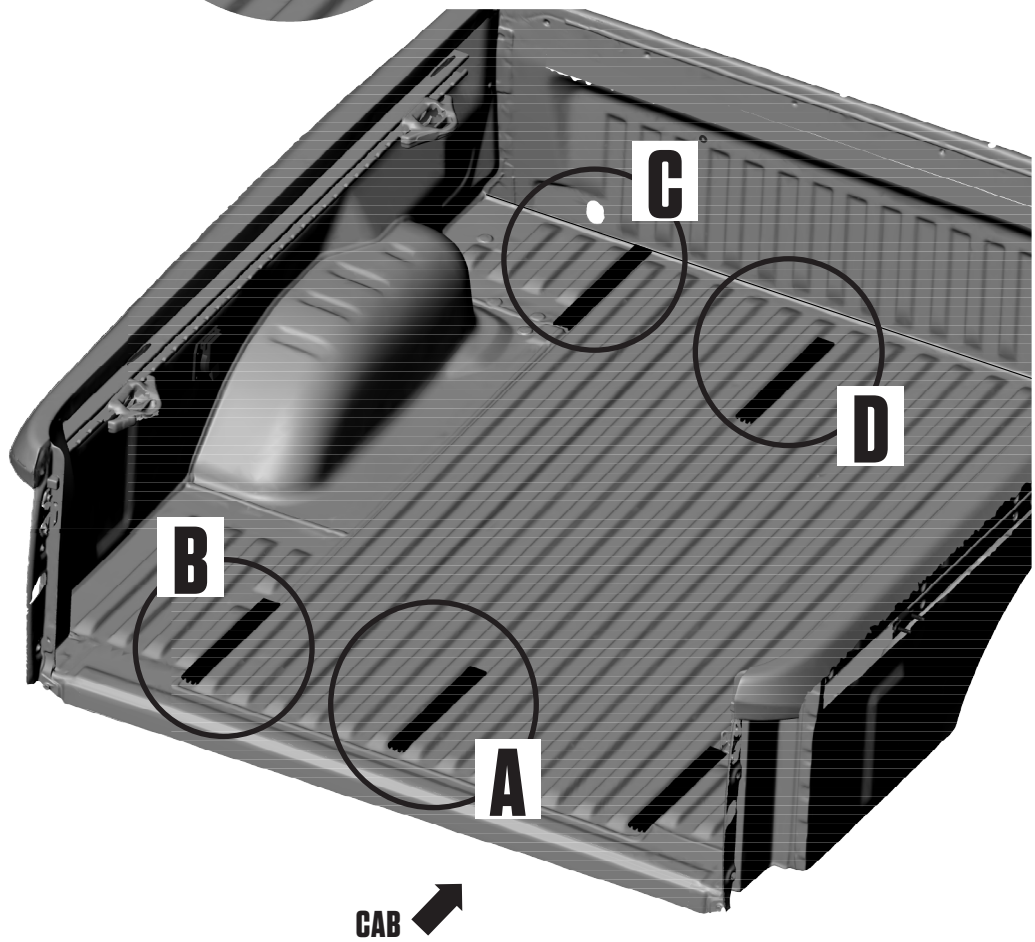
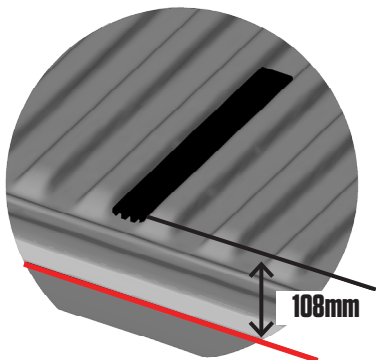

PREP BED: MARK BULKHEAD HOLES

- Referencing centreline of bed line marked previously, measure 350mm from each side of centreline and mark a vertical line. NOTE: Vertical line should be on a raised bead, not a channel.
- Intersect vertical lines drawn with a horizontal line 64mm above top of floor bead.
- Align bottom of bracket with 64mm horizontal reference line; **BAG PREP MS1**.
- Centre holes in bracket over vertical reference line.
- Mark hole locations.
- Repeat for other side.

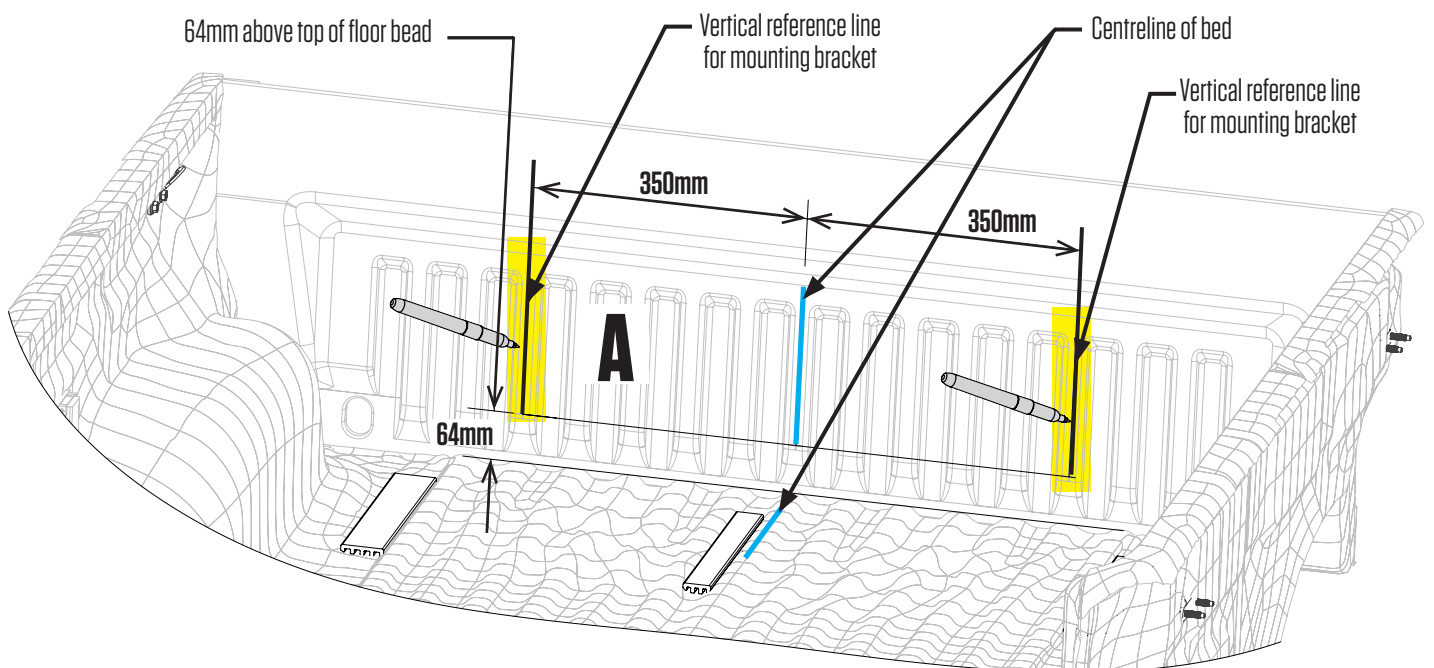
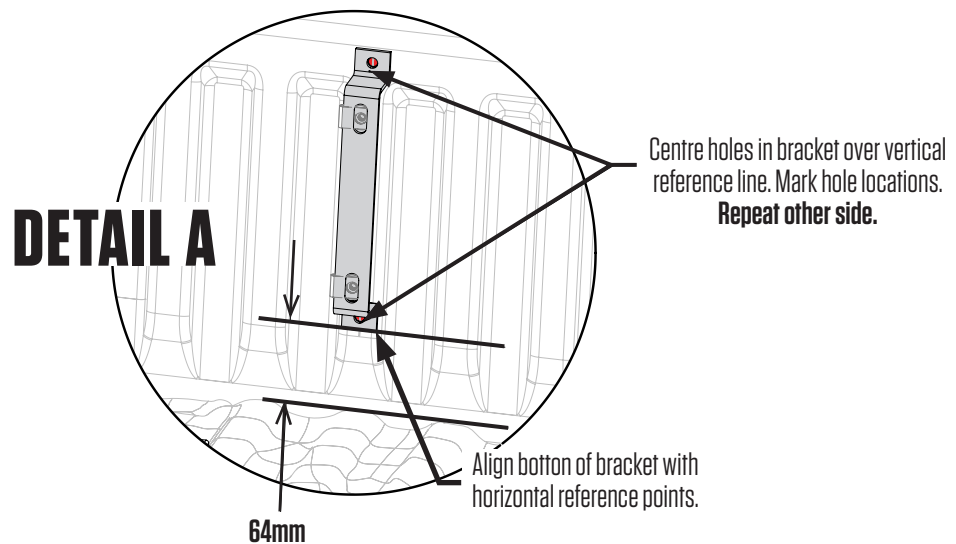

HELPFUL TIP: Your bed pattern looks slightly different to this image...Don't worry, it's just a visual aid.

PREP BED: DRILL CABSIDE HOLES AND INSTALL JACKNUTS

- Drill (4) 11mm holes where previously marked. Use a drill stop on your drill bit, set to 6mm depth (see image below).
- **IMPORTANT:** to resist corrosion, make sure to seal the raw metal edges of the drilled holes with self-etching primer which is available at most auto supply or hardware stores.
- Install jacknut onto install tool and insert 25.4mm screw; **BAG PREP MS1**.
- Insert jacknut into hole and while holding install tool, tighten screw head with ratchet until you are unable to tighten screw further, jacknut is fully crimped. Remove screw.
- Repeat process for other three holes using the same set screw.

NOTE: If installer has access to a rivnut installation tool, M8-1.25 rivnuts can be substituted for the supplied jacknuts. If rivnuts are used, replace the supplies screws with M8-1.25 x 25 long screws.

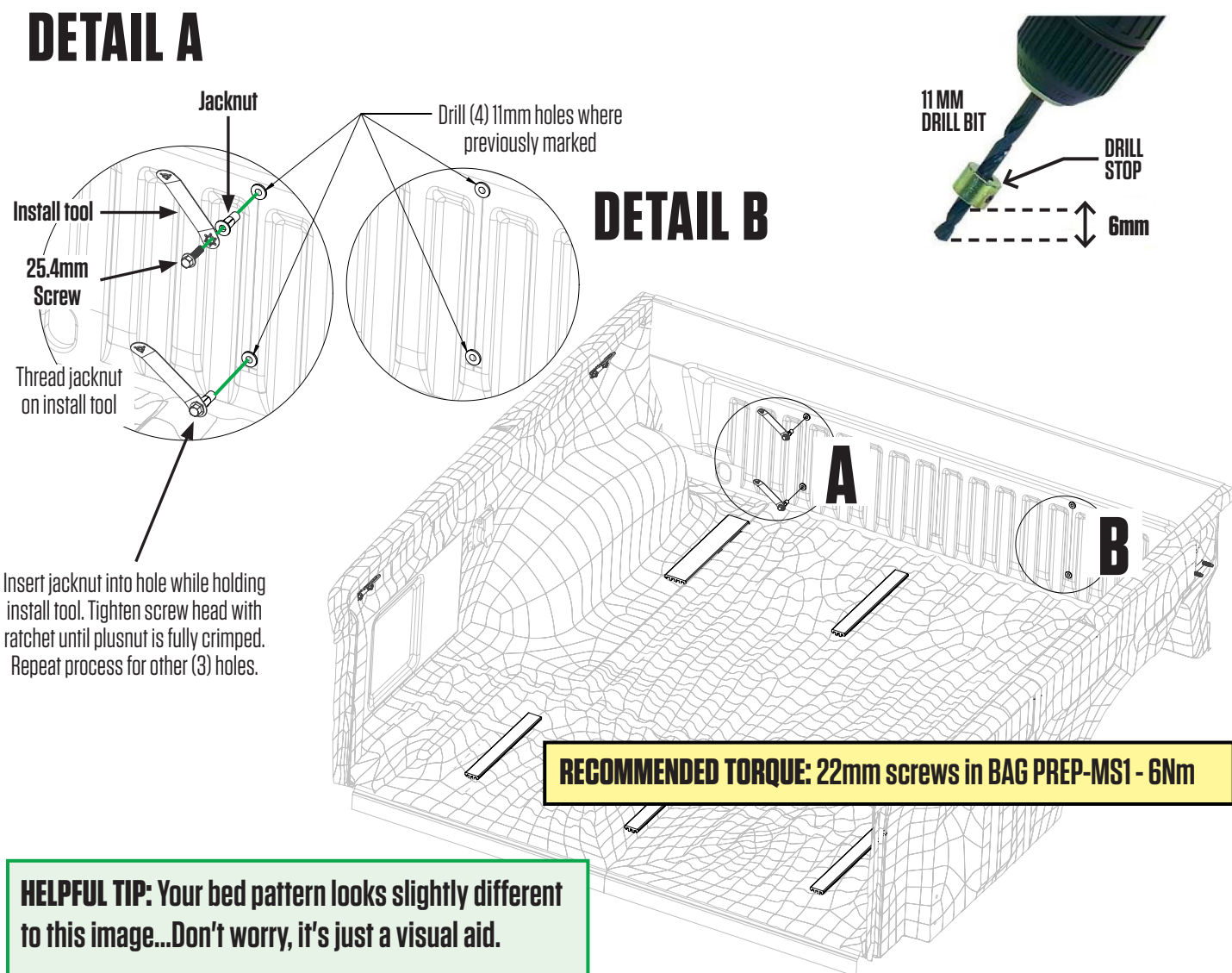

PREP BED: INSTALL MOUNTING BRACKETS

- Install u-nuts onto mounting brackets as shown. The threaded portion of the u-nut must be on the interior of the bracket.
- Locate cabside mounting bracket over jacknuts.
- Insert 22mm dogpoint screws; **BAG PREP MS1** through bracket into jacknut. Tighten securely. NOTE: These are the same screws as the dogpoint screws in your S1 BAG.
- Repeat steps for other mounting bracket.

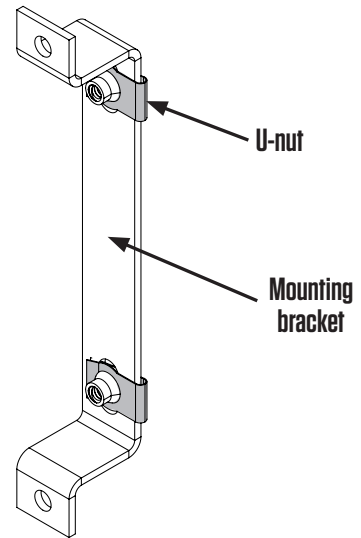

RECOMMENDED TORQUE: 22mm screws in BAG PREP-MS1 - 6Nm

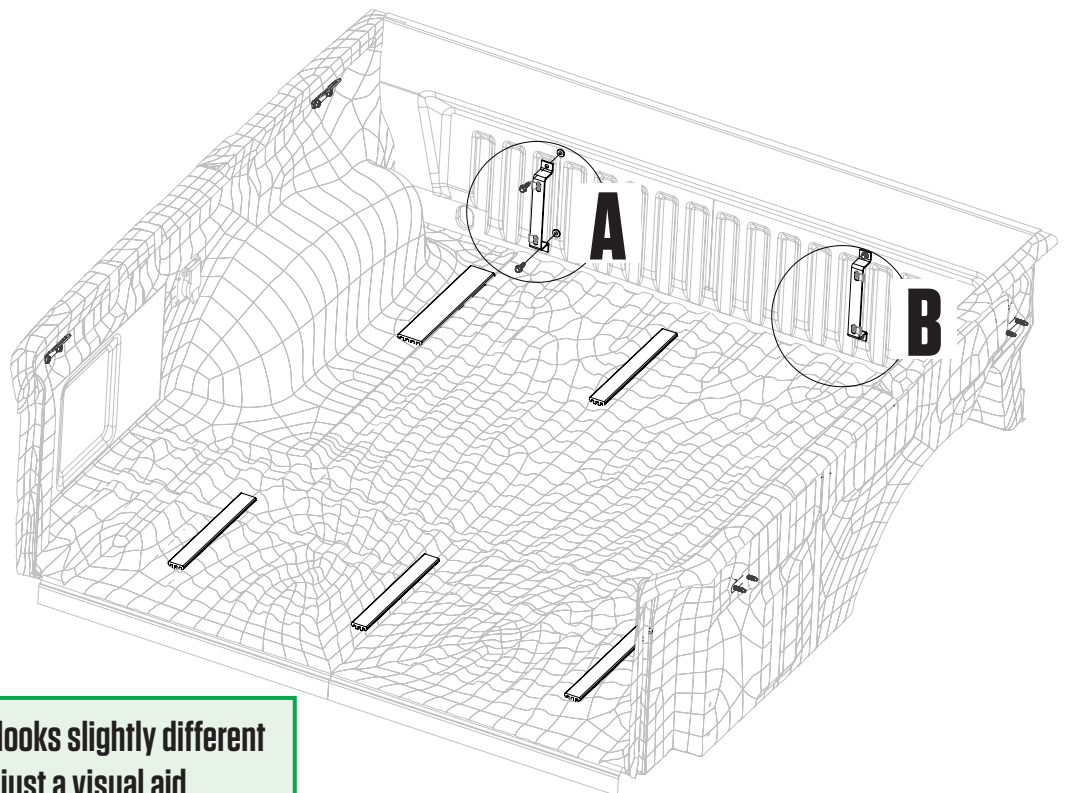
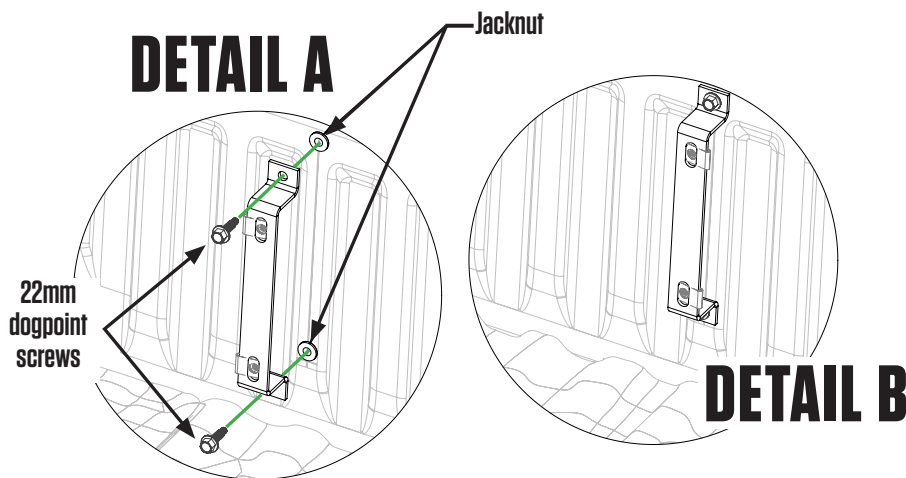

HELPFUL TIP: Your bed pattern looks slightly different to this image...Don't worry, it's just a visual aid.

PREP BED: TAILGATE BRACKET

NOTE: You will need assistance for this step.

- **STEP 1:** Mark holes as shown.
- **STEP 2:** At both mark locations, drill two 8mm holes using a 6mm drill stop.
- **STEP 3:** Install tailgate tiedown bracket; BAG PREP-MS1. **IMPORTANT:** Orient bracket hook towards cab as shown.
- Repeat other side.

STEP 1

Mark hole locations as shown.

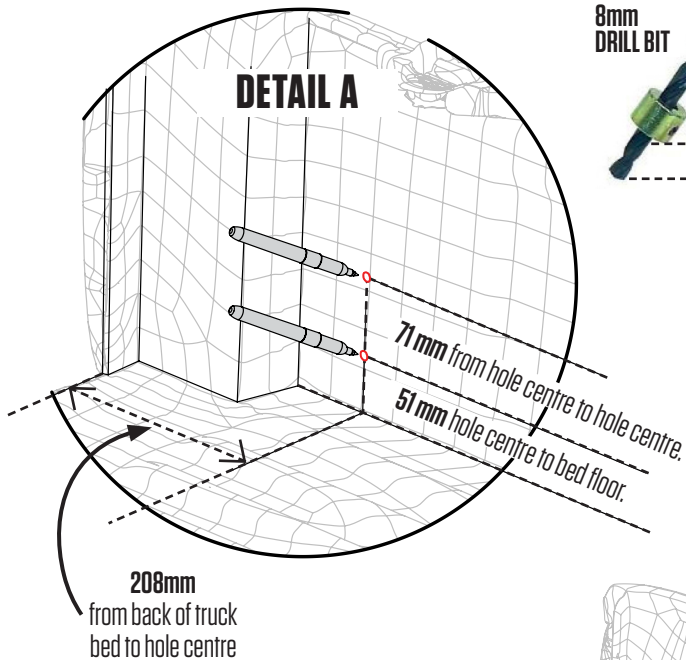

STEP 2

At both mark locations, drill a 8mm hole using a drill stop set to 6mm.



STEP 3

Install tailgate bracket and backing plate as shown with two 2.54cm screws and flanged nuts. Securely tighten.

NOTE: You will need assistance for this step.

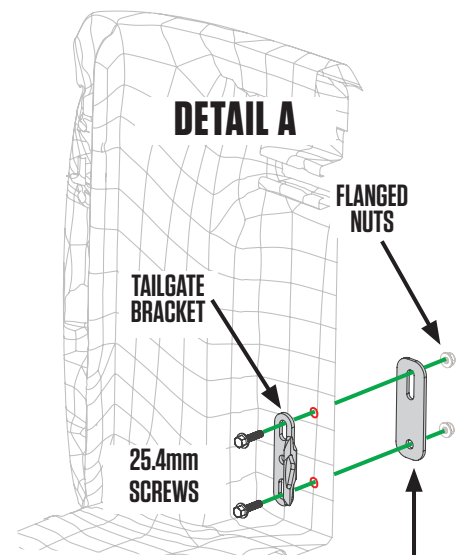

BACKER PLATE GOES OUTSIDE THE INNER BED ON THE INTERIOR WHEEL ARCH.

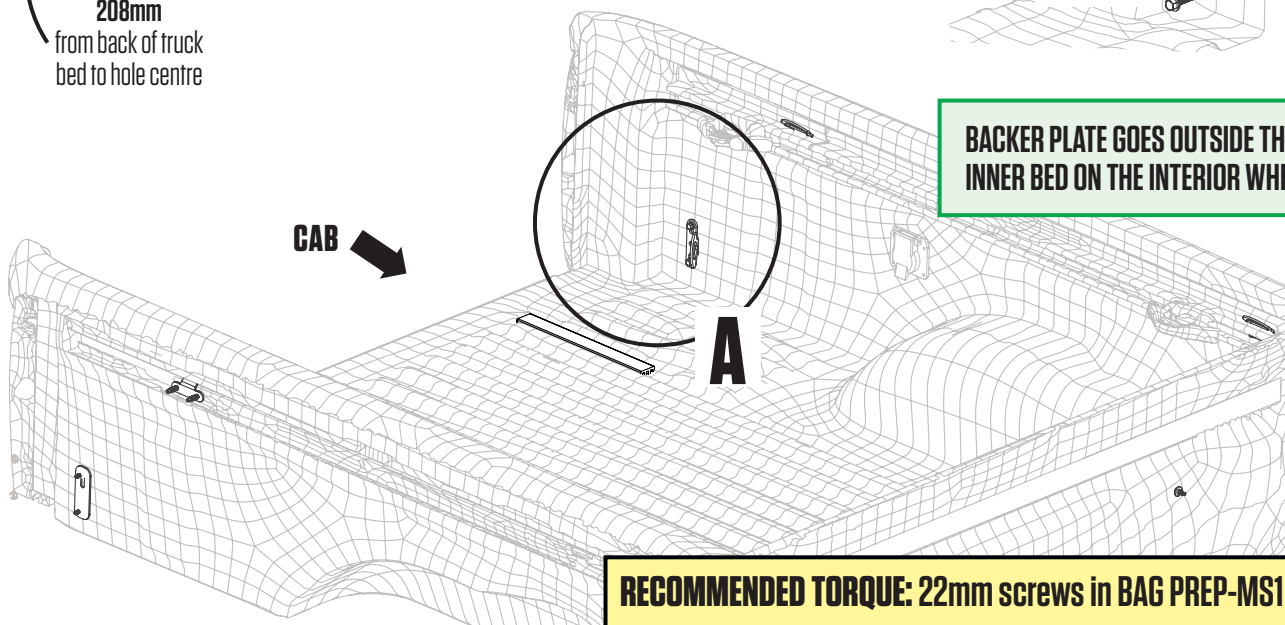

RECOMMENDED TORQUE: 22mm screws in BAG PREP-MS1 - 6Nm

ASSEMBLY: CENTRE VERT + CABSIDE VERT

NOTE: Perform the next few steps on a flat surface.

- Attach centre vert to cabside vert with four screws. Alternate to tighten; BAG S1.

NOTE: We've provided a 3/8" socket for the S1 screws in your; BAG PREP-MS1.

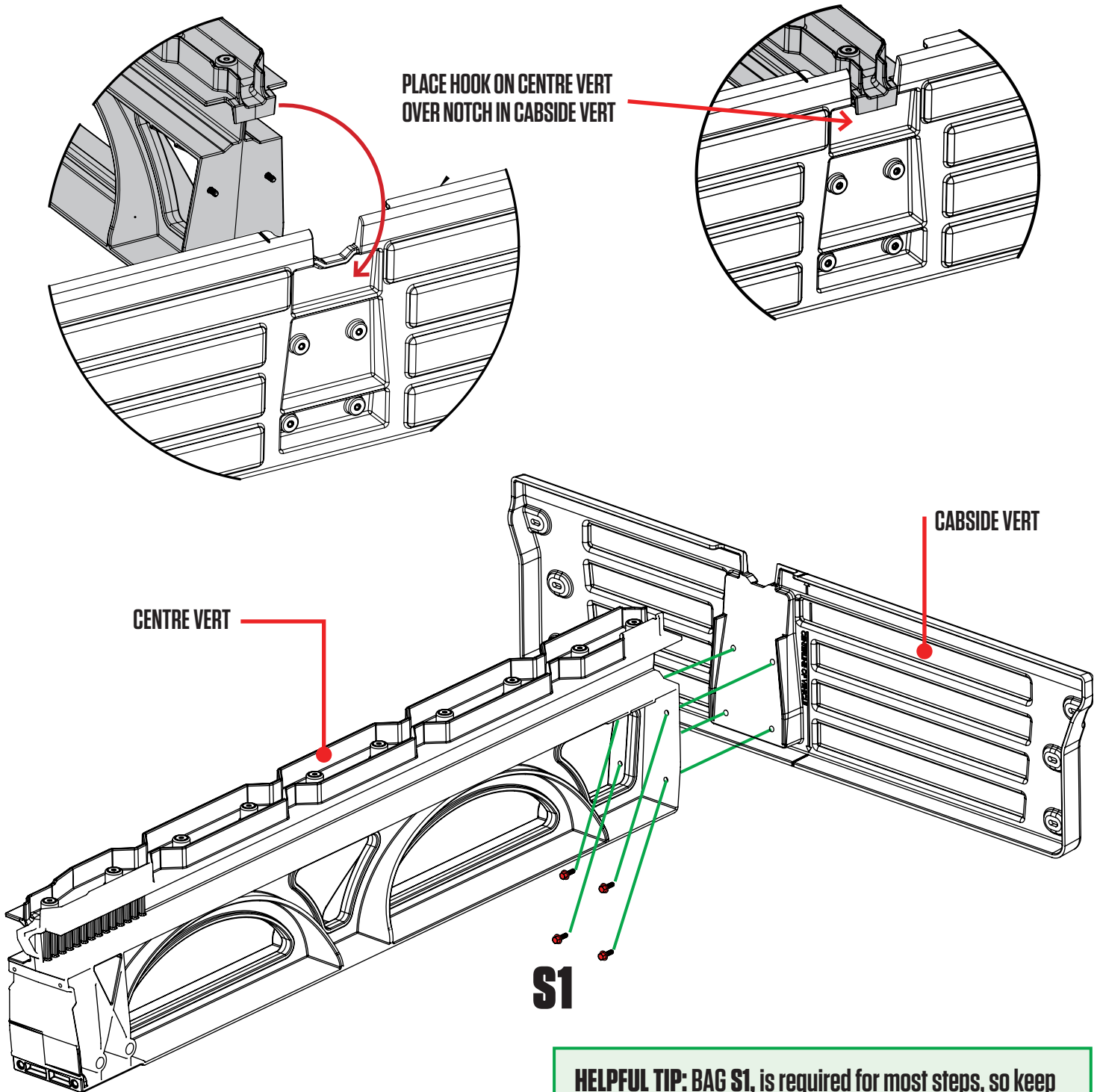

RECOMMENDED TORQUE: 22mm screws in BAG S1 - 3Nm

HELPFUL TIP: BAG S1, is required for most steps, so keep it to hand. These fittings are highlighted throughout instructions in **RED**.

ASSEMBLY: LOOSELY ATTACH STUDS

- **LOOSELY** attach studs to cabside vert with six screws; BAG **S1**.

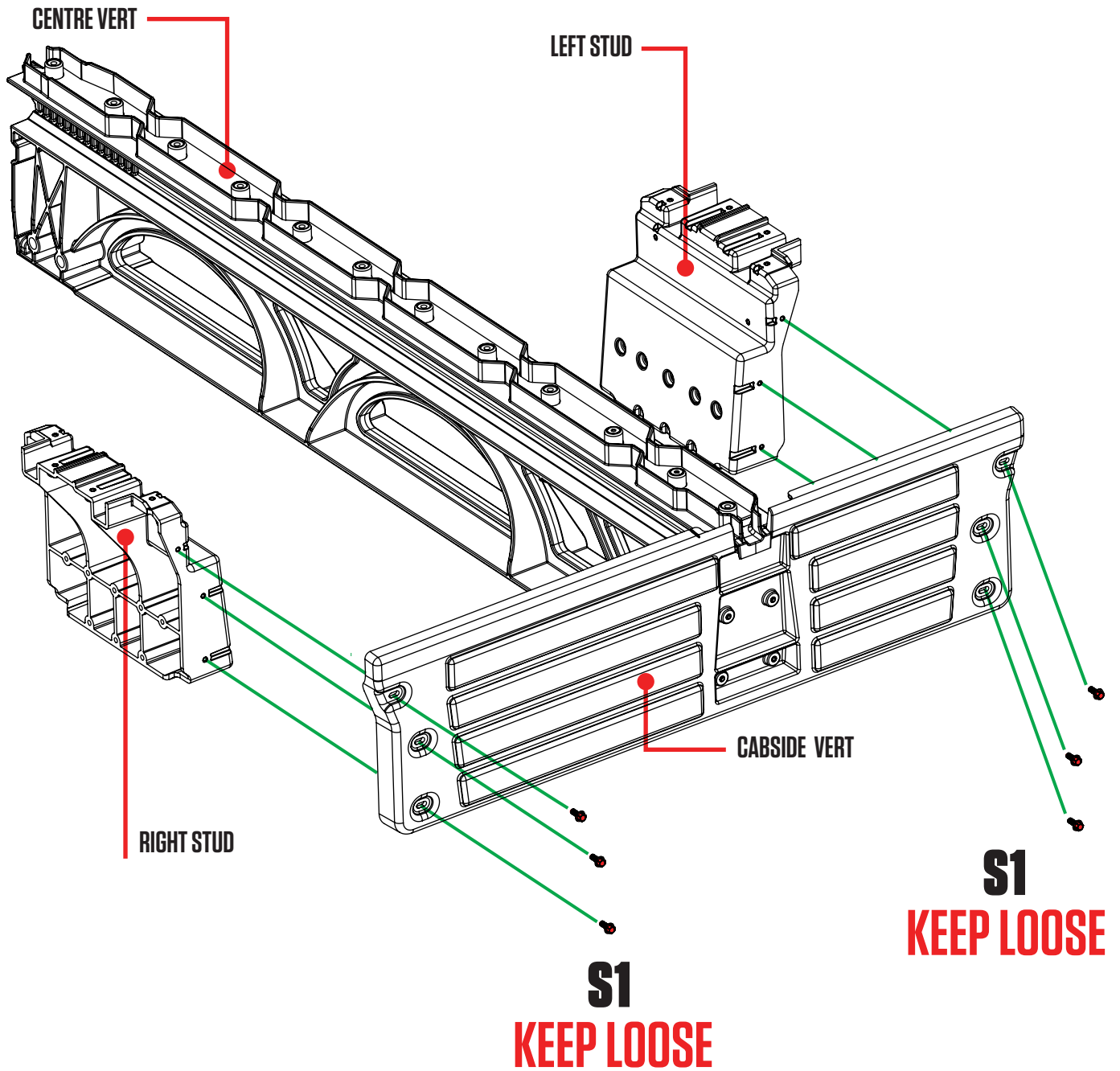

RECOMMENDED TORQUE: 22mm screws in BAG S1 - 3Nm

ASSEMBLY: ALIGN & TIGHTEN STUDS

NOTE: This step ensures the studs are properly located before tightening screws. It's important.

- Place storage boxes to support tailgate end of deck panels.
- Lift deck panels on centre vert + stud + cabside vert assembly.
- Slide studs around L-R until deck panels are seated.
- **DETAIL A:** Loosely secure four screws to hold decks onto studs; **BAG S1**.
- Now you can securely tighten the screws that hold the studs to the cabside vert.
- Unscrew deck from studs, remove deck panels, save screws, remove storage boxes and set aside for later assembly.

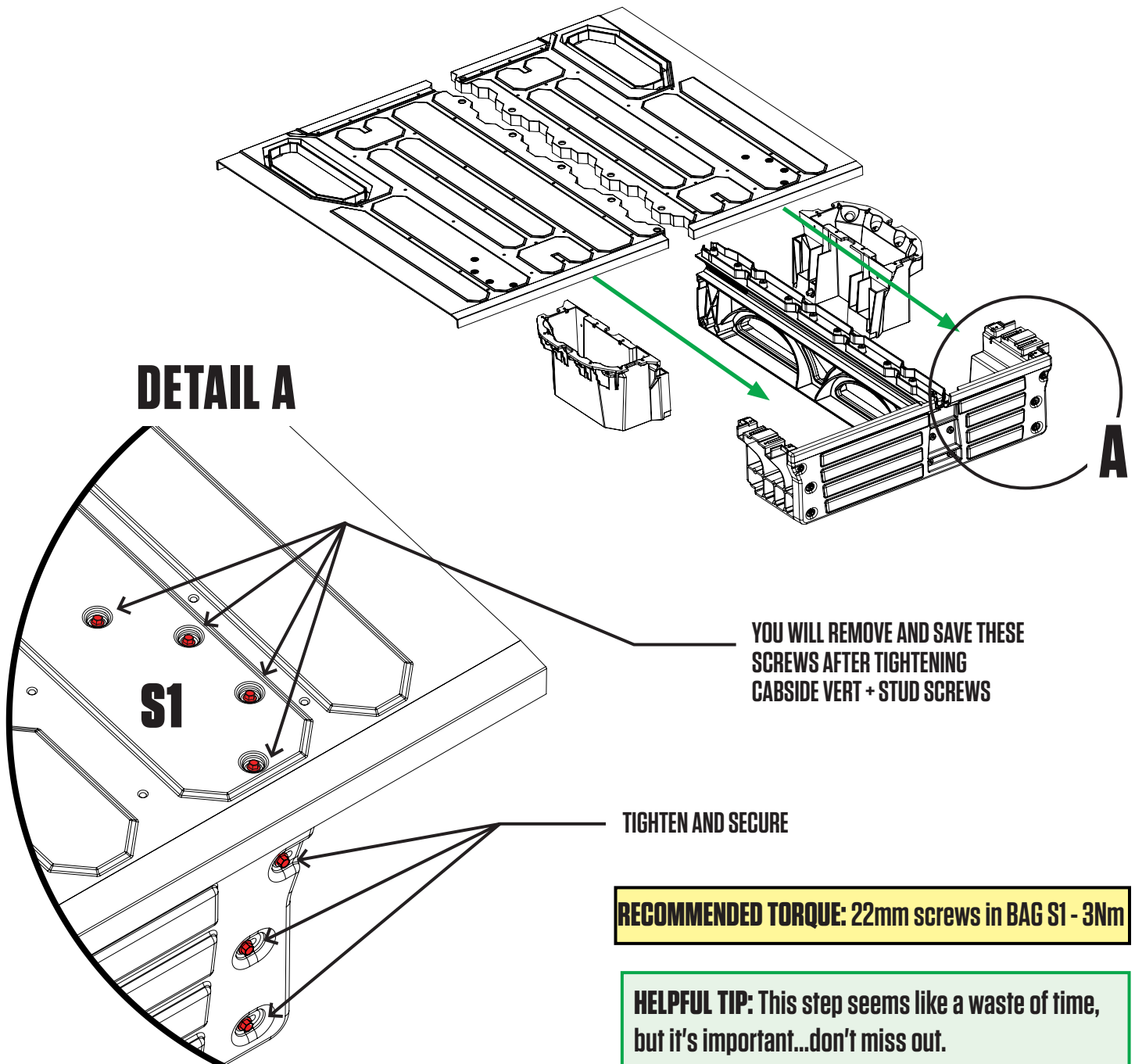

INSTALL: MOUNT ASSEMBLY

- While supporting both ends, lift centre vert + stud + cabside vert assembly in ute bed. Position against cabside panel of ute.
- Align with U-nuts in mounting brackets.
- Secure assembly using two 22mm dogpoint screws and two washers; BAG PREP-MS1. **NOTE: These are the same screws as the dogpoint screws in your S1 BAG.**
- Repeat other side.

DETAIL A

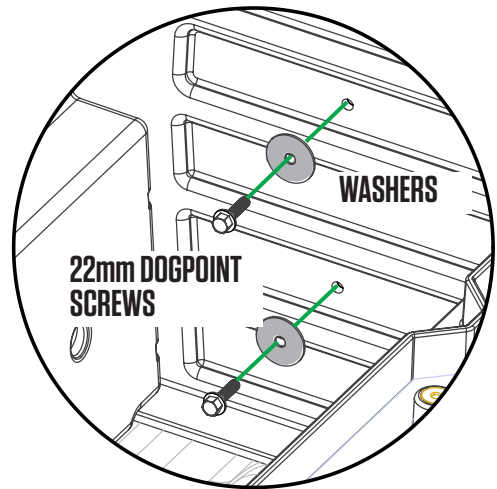

RECOMMENDED TORQUE: 22mm screws in PREP-MS1 BAG - 6Nm

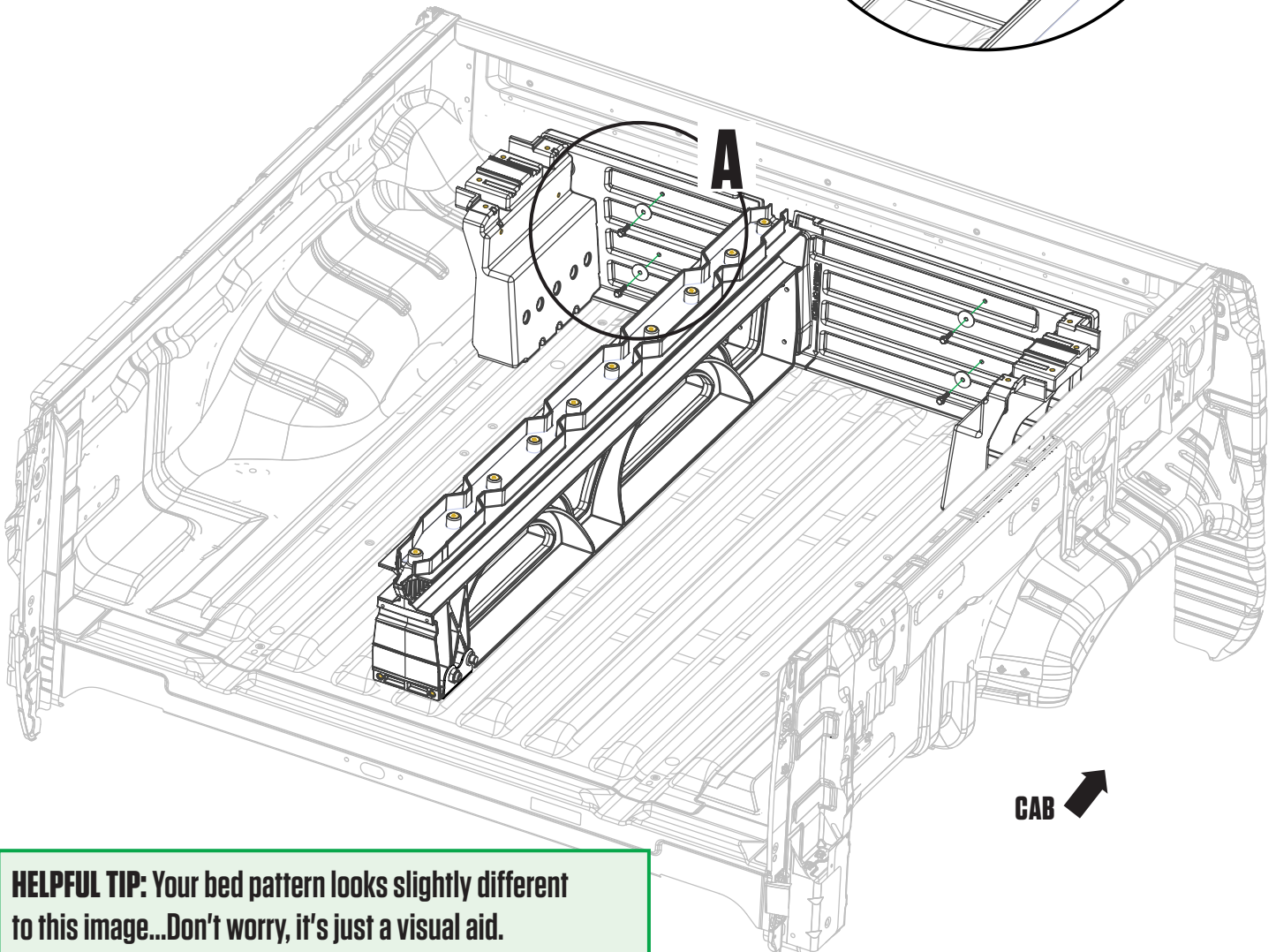

HELPFUL TIP: Your bed pattern looks slightly different to this image...Don't worry, it's just a visual aid.

INSTALL: C-CHANNEL

IMPORTANT: There is a **LEFT** and **RIGHT** storage box. The inside of each storage box is marked **L** or **R**.

- Loosely place left box at tailgate corner of bed.
- Place left C-channel on ledge of stud and storage box with end plate forward.
- **DETAIL A:** Insert two screws through C-channel into storage box and **loosely** fasten with nuts; **BAG S2**, **BAG N1**.
- **DETAIL B:** Attach C-channel to stud; **BAG S1**.
- Repeat right side.

DETAIL A KEEP LOOSE

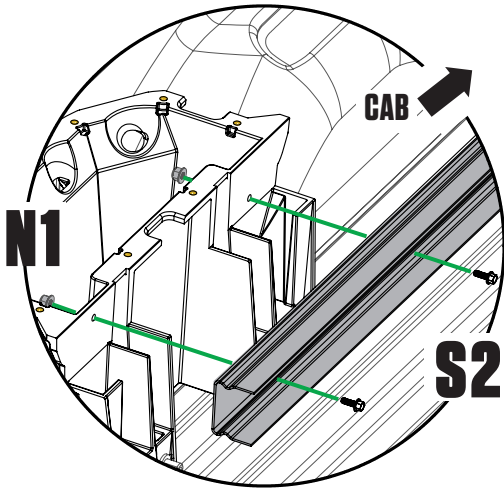

DETAIL B TIGHTEN

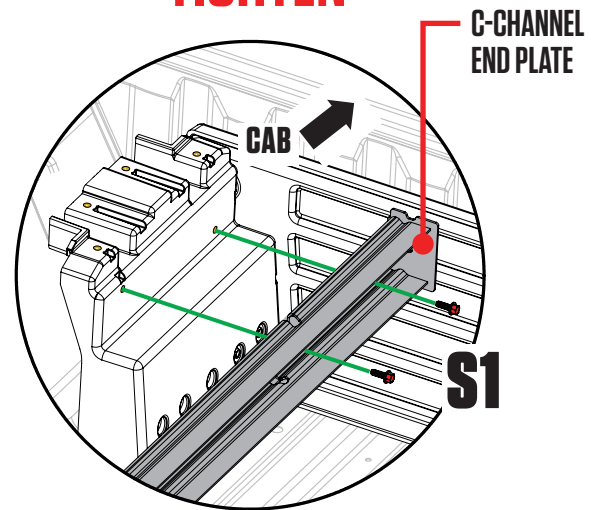

HELPFUL TIP:
Make sure the **LEFT** storage box goes on the **LEFT** side.
The inside of each storage box is marked **L** or **R**.

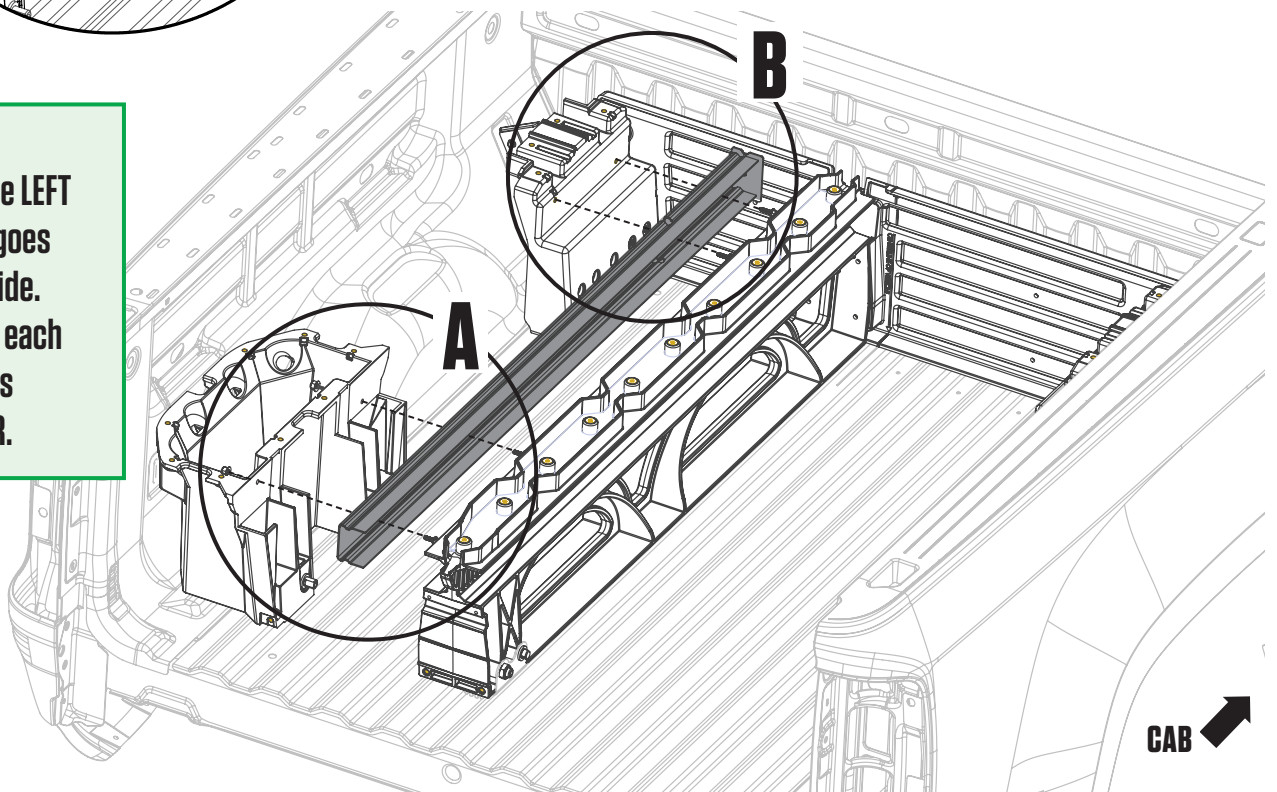

INSTALL: DECK HALVES

- Loosely place deck panel on side stud, centre vert and storage box.
- Shift storage box forward, rearward, L-R, as necessary to align with fully seated deck panel.
- Loosely assemble:
 - Five screws through deck panel into centre vert; **BAG S1**.
 - Four screws with nylon and rubber washers installed as shown through deck panel into stud; **BAG S1, BAG MS WASHERS**.
 - Eight screws with nylon and rubber washers installed as shown through deck panel into storage box; **BAG S1, BAG MS WASHERS**.
 - Tighten all **S1** screws.
 - **Securely tighten C-Channel/storage nuts and screws.**
- Repeat other side (**making sure you don't forget to securely tighten C-channel/storage box nuts and screws**).

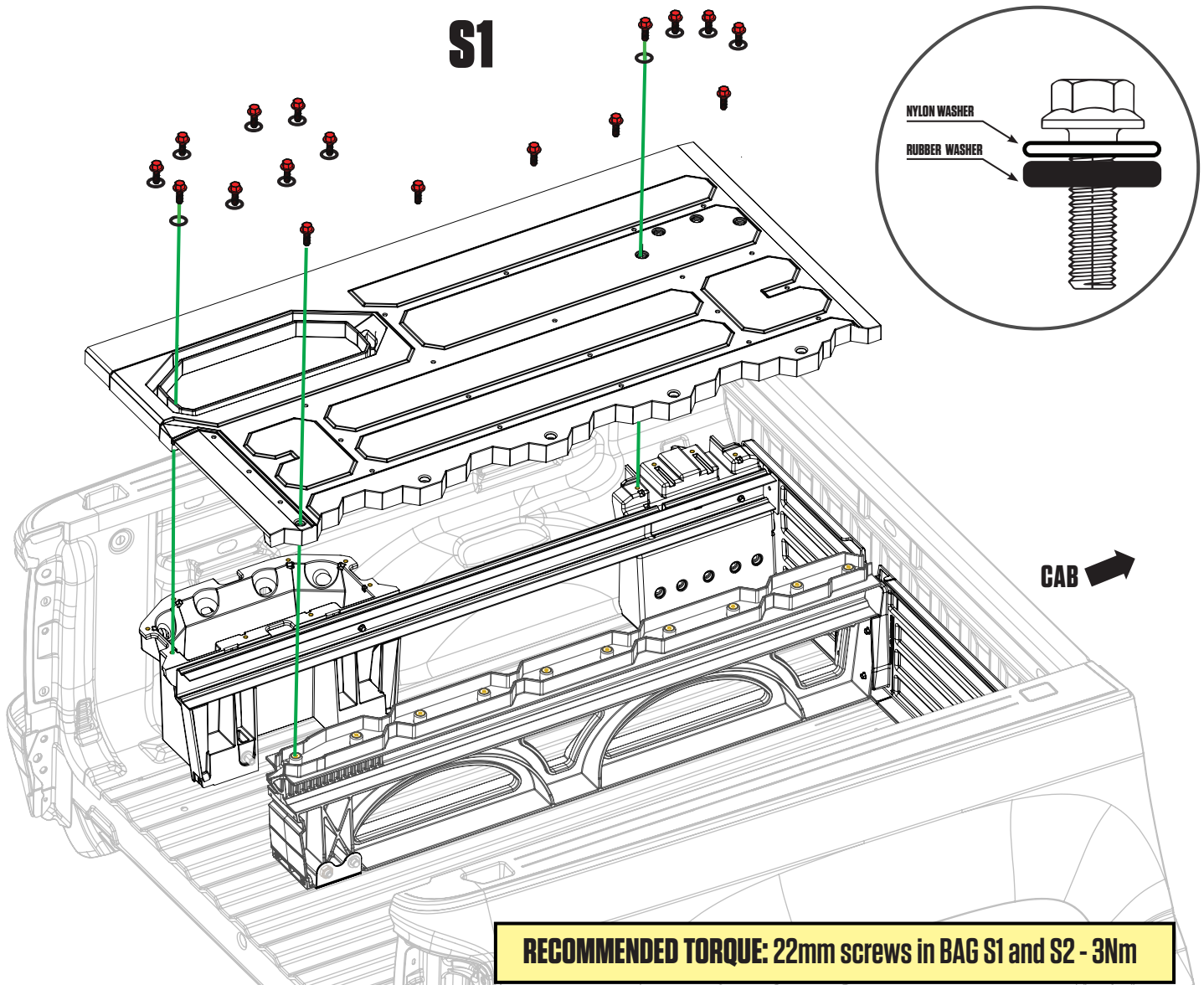

INSTALL: J-HOOKS

- **Loosely** assemble J-hook assembly in order shown through the second closest hole to the **TAILGATE** in ammo can; BAG J8. **IMPORTANT: Keep J-hook assembly loose.**
- Repeat other side.



CAB

Orient ammo can J-hooks to open with hook toward cab.

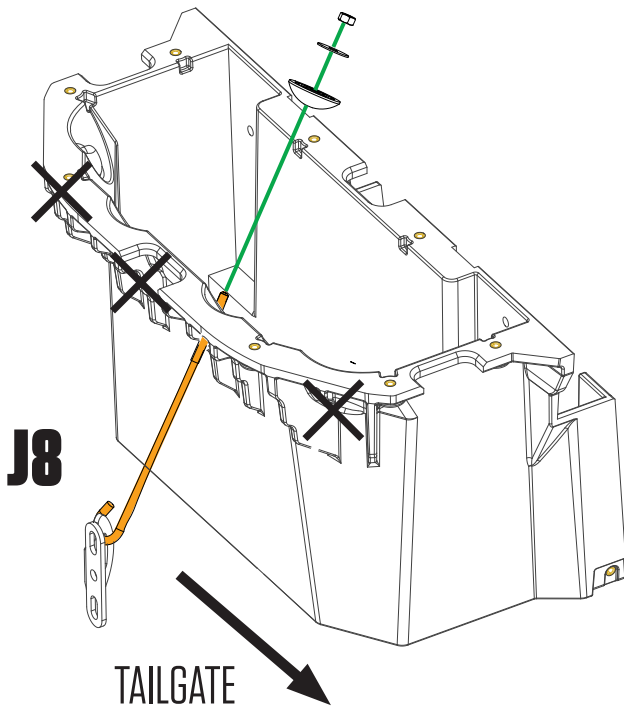

LEFT STORAGE BOX
KEEP LOOSE

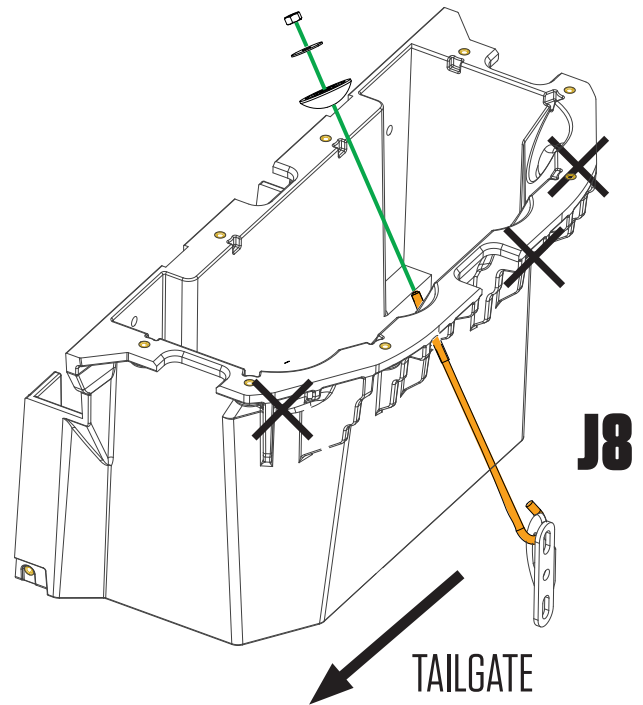

RIGHT STORAGE BOX
KEEP LOOSE

RECOMMENDED TORQUE: Nuts in BAG J8 - 1Nm

DRAWERS: BRACKETS + WHEELS

- Each drawer has a left and a right bracket. Fix brackets into place via bottom two holes in bracket with 19mm length screws. Use the 50mm length screws for the upper cabside wall hole in bracket; **BAG DRAWER 1**.
- Install a tube brace in each drawer with two 19mm length screws; **BAG DRAWER 1, BAG DRAWER 2**.
- Attach wheels onto drawer brackets with a 7/32" Allen key; **BAG WHEELS**.

NOTE: We've provided an Allen key in your BAG PREP-MS1.

RECOMMENDED TORQUE:
Wheel screws - 10Nm;
All other screws - 3Nm

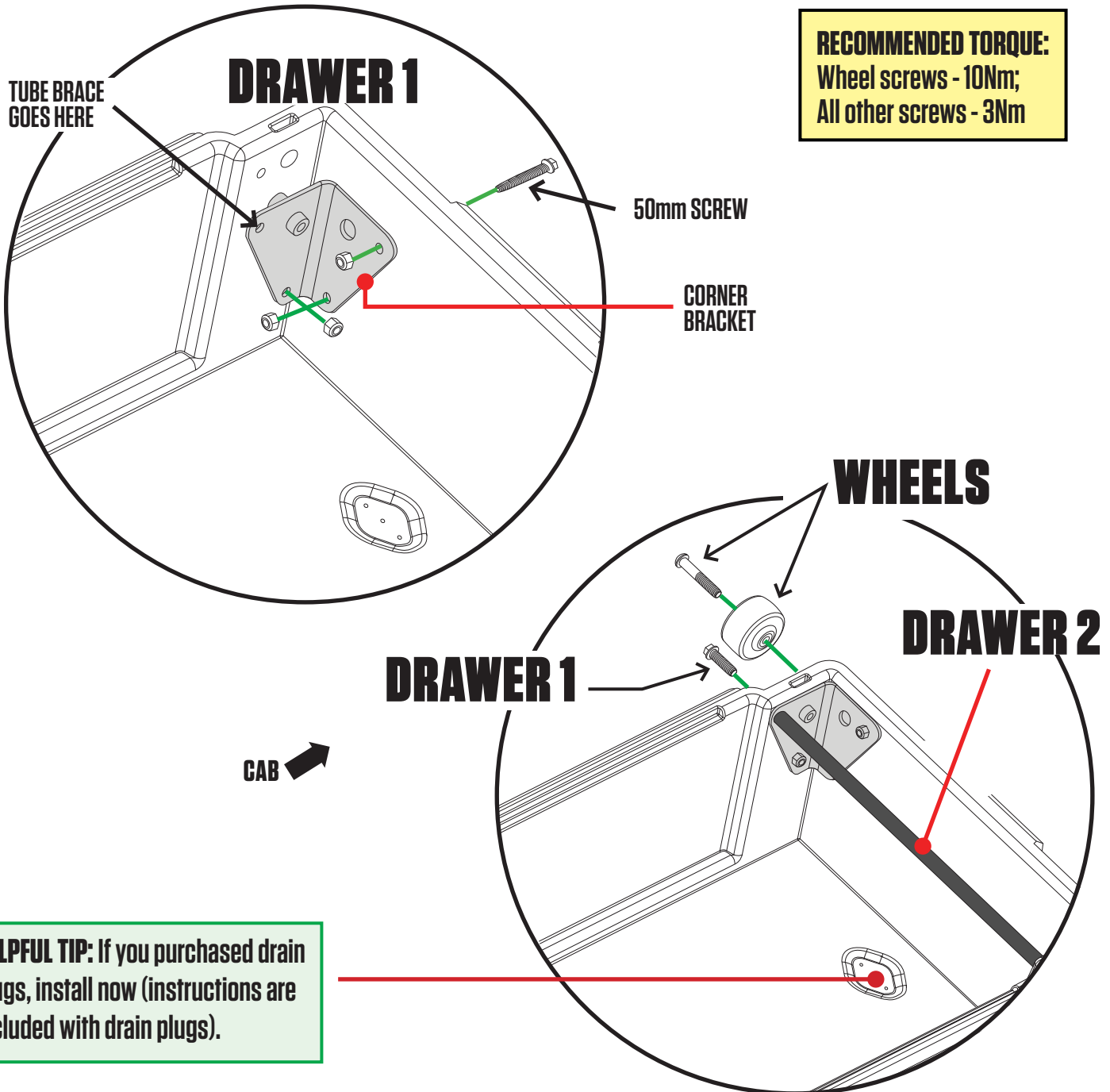

DRAWERS: AXLE WHEELS + WEATHERSTRIPS

- Slide narrow drawer into the left side drawer cavity. **NOTE: It is easier to fully install narrow drawer first.**
- **DETAIL A:** Install two tailgate wheels onto narrow drawer axles with a 7/32" Allen key; **BAG WHEELS.**
NOTE: We've provided an Allen key in your BAG PREP-MS1.
- Repeat with wide drawer.
- **DETAIL B:** Install weatherstrips on top of drawer edges **WITH WIPER BLADE POINTING TOWARD DRIVER.**
IMPORTANT: Incorrect installation of the weatherstrip will funnel water into the drawer!

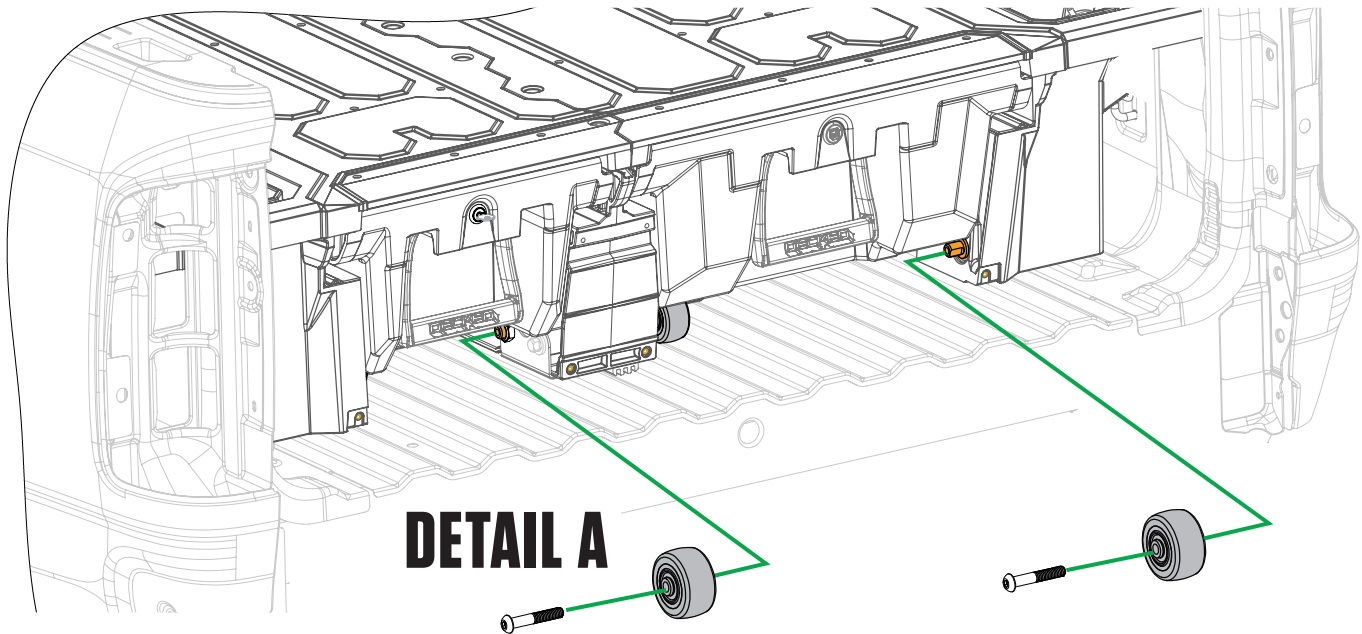

RECOMMENDED TORQUE:
Wheel screws - 10Nm

HELPFUL TIP: To make this step easier, support the drawer on a piece of material (approx 50mm) or have an assistant hold the drawer up against the deck.
HELPFUL TIP: Cut weatherstrips if they overhang.

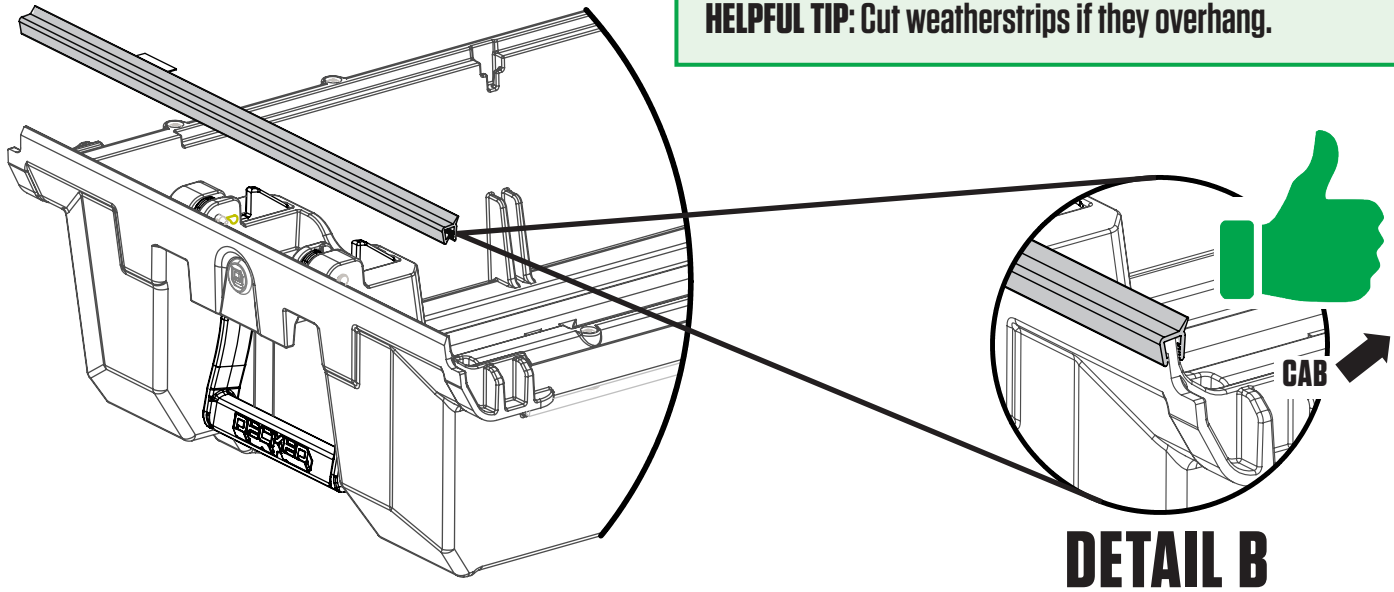

FINAL STEPS: TORSION BRACE + BOTTLE OPENER

- Slide torsion brace under centre support and tailgate storage boxes.

NOTE: Ensure the J-hooks are not tight.

- Loosely install:

- Two screws with nylon washers through the end holes in torsion brace into storage boxes; **BAG S1**.
- Two screws with nylon washers through the bottom bottle opener holes and torsion brace into centre vert; **BAG S1**.
- Two 13mm length screws through upper holes in bottle opener into centre vert; **BAG FINAL MID**.

- Align bottle opener to edges of centre vert and tighten four bottle opener screws.

- Tighten end screws into tailgate storage boxes.

- **Finally, tighten the J-hooks! DO NOT OVER TIGHTEN. Make sure the gap between the sidewall of the bed and the deck is equal on both sides.**

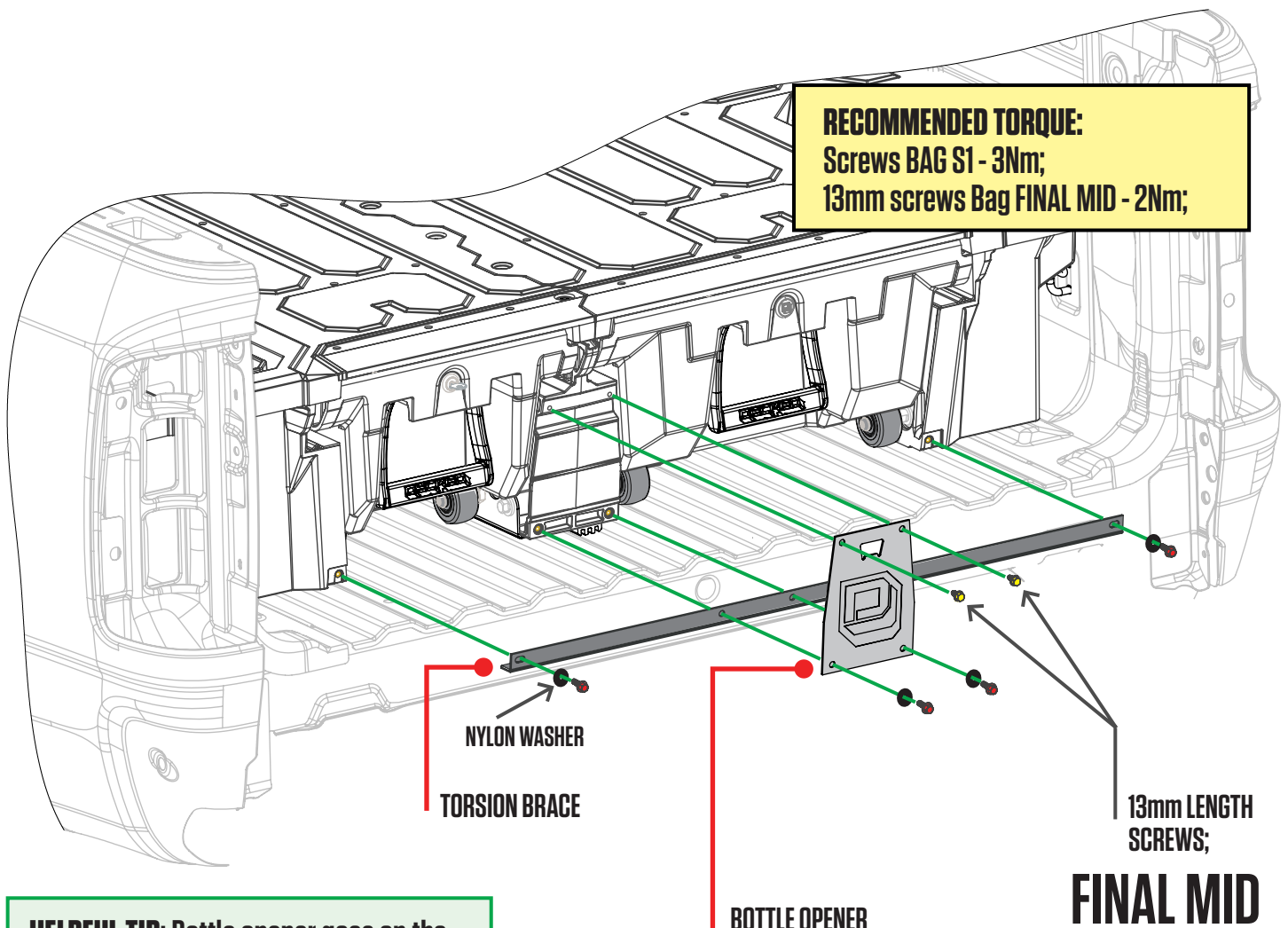

HELPFUL TIP: Bottle opener goes on the outside of torsion brace.

FINAL STEPS: THE RULER

- Centre ruler in embossed area and screw three 13mm length Phillips screws through the tailgate side holes directly into deck panels; BAG FINAL MID.

NOTE: These are small gauge screws. Light hand tighten ONLY.

- For the three cabside ruler mounting holes, drill each with a 3.5mm bit and a drill stop set to 12mm. There is a lateral steel tube that runs on the underside of the deck at this location. (SEE UNDERSIDE VIEW OF DECK).

IMPORTANT: Only drill through TOP of steel tube; do not drill through bottom of tube, otherwise you will funnel water into your drawers; BAD!

- Screw three 19mm length Phillips screws into the cabside ruler holes you just drilled; BAG FINAL MID.

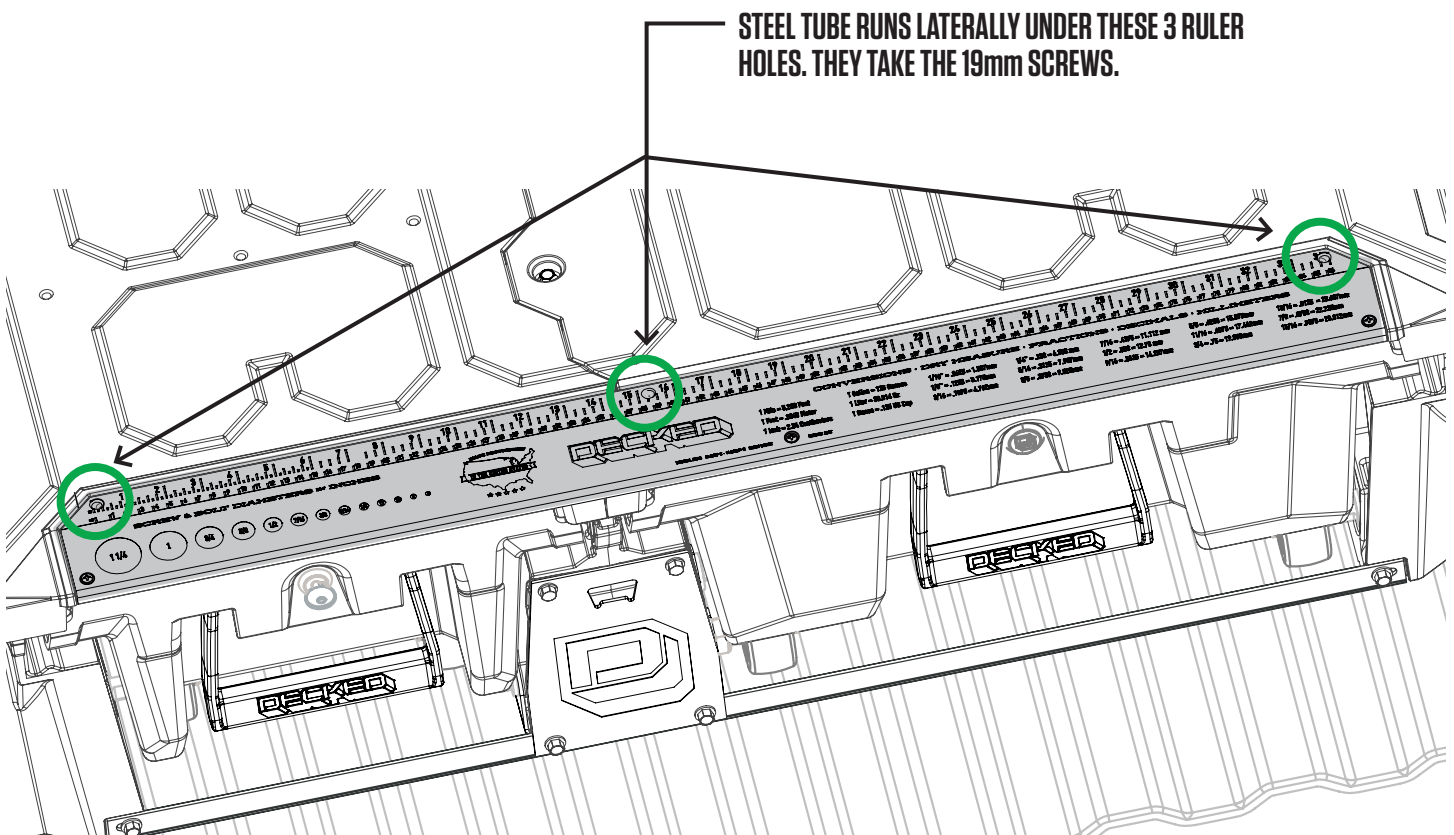

UNDERSIDE VIEW OF DECK

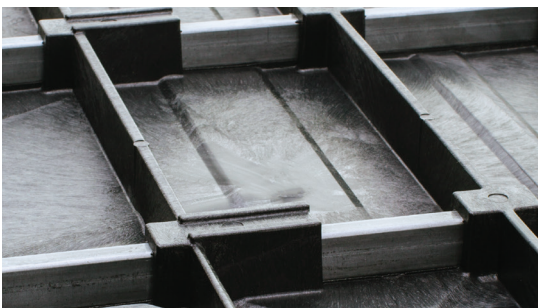

DO: Drill through the top of steel tube ONLY.

DO NOT: Drill through both sides of steel tube.



INSTALL: CLOSEOUT ANGLE

- Referencing the orientation sticker, THIS SIDE UP, orient and trial fit the cabside closeout angle at the cabside end of the bed.
- Clean the vertical surfaces of the cabside panel of the bed where the adhesive tape on the closeout angle will contact the bed.
- Remove protective layer from the tape strips to expose the adhesive surface.
- Place the closeout angle up against the cabside panel of the bed and apply with pressure.

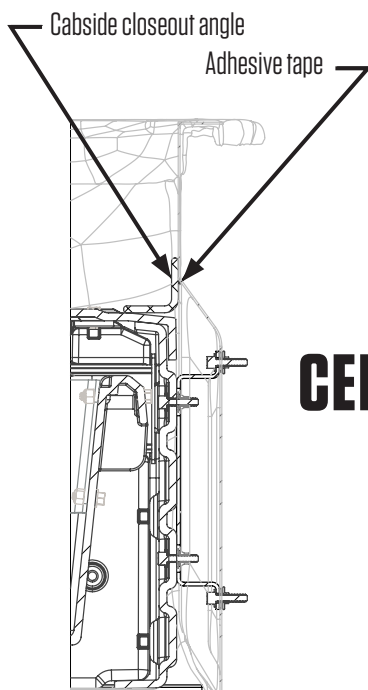
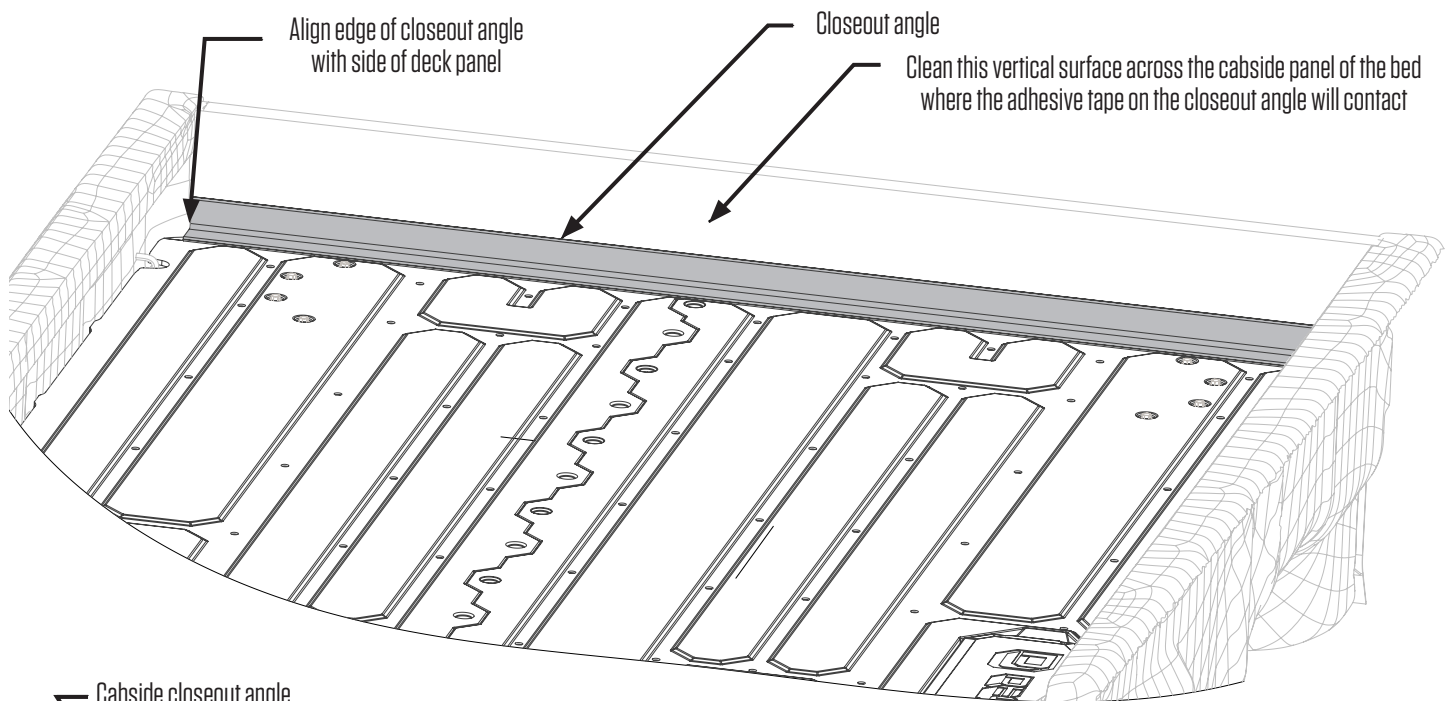

CENTRELINE SECTION

FINAL STEPS: STORAGE BOX LIDS

- **DETAIL A:** Storage box lids are left (marked L) and right (marked R) side specific.
- **DETAIL B:** Holding lid in orientation shown, insert tab on tailgate end of storage box lid and push the cabside end of lid down to secure. Don't be afraid to push down hard.
- Insert lock hole plugs, unless you are fitting the optional drawer locks, in which case install drawer locks now (instructions with locks); **BAG FINAL MID.**

DETAIL A

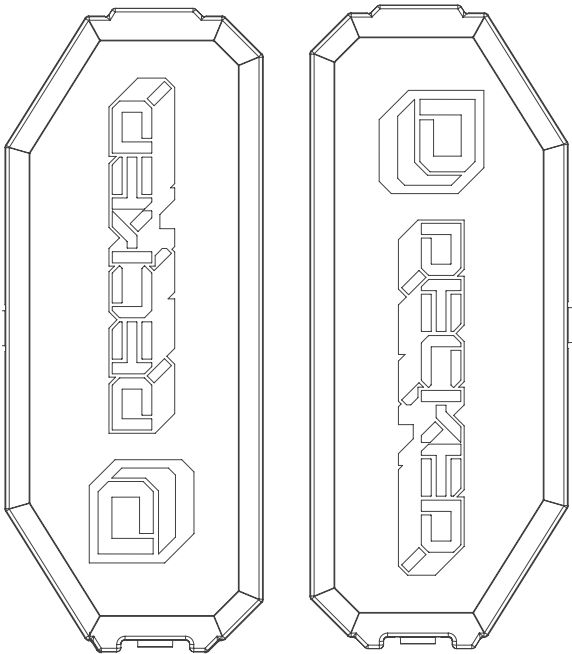

LEFT STORAGE
BOX LID

RIGHT STORAGE
BOX LID

DETAIL B

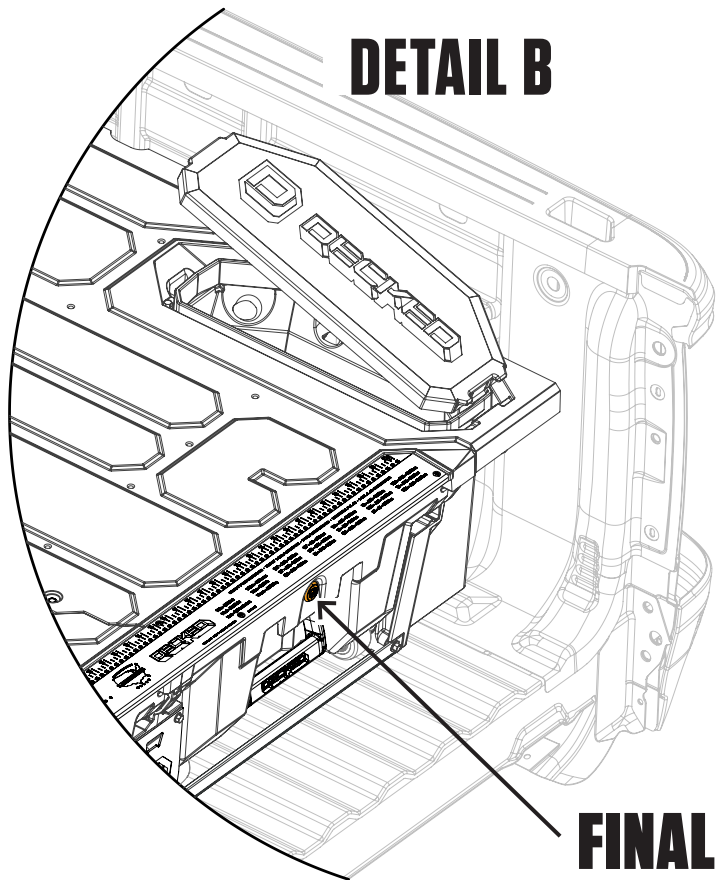

FINAL MID

DECKED 3-YEAR LIMITED WARRANTY

DECKED LLC warrants to the original purchaser of this product that the product will be free from manufacturing defects in workmanship and materials for a period of three (3) years from the date of the original purchase. If within three (3) years from the original date of purchase this product fails due to defect in materials or workmanship, DECKED LLC will replace any defective part at its option.

The original purchaser must contact the DECKED LLC customer service team and provide a description of the defective part, including digital pictures if requested, with the original purchase documentation as validation of warranty coverage or have previously activated their warranty online.

This warranty DOES NOT cover or apply to:

- Damage to the product due to misuse, mishandling and abuse.
- Products not used in accordance with the manufacturer's instructions or recommendations.
- Product not assembled or installed according to manufacturer's instructions.
- Normal wear and tear.
- Undeclared damage to the system during shipping, acts of God. In addition, consequential damage and incidental damages (including lost time) such as damage to persons or property are not covered under this warranty.

REGISTER YOUR PRODUCT FOR ANY FUTURE WARRANTY NEEDS AS WELL AS TO BE INFORMED OF PRODUCT IMPROVEMENTS, ISSUES OR SOLUTIONS SPECIFIC TO YOUR MODEL [**DECKED.COM/REGISTER**](https://www.decked.com/register)